

**Contact Us**

**SUNSETMESA.ORG**  
**EMAIL: [SMPOABoard@gmail.com](mailto:SMPOABoard@gmail.com)**  
 For President put *President* in the subject line  
 For Treasurer put *Treasurer* in the subject line  
 For Advertising put *Advertising* in the subject line  
**Architecture Committee: [sunsetmesaac@gmail.com](mailto:sunsetmesaac@gmail.com)**

**Next Board Meeting: Monday, October 3rd @ 7:30pm via Zoom (please email for link)**

***Presidents Message by Seth Fonti, President***

**Coming Together as a Community**

This month as fall arrives we have two compelling opportunities to bring the community together for the first time since the pandemic.

***Block Party 10/29:***

The Board and a group of dedicated and hard working volunteers have been doing an incredible job mobilizing and planning our community Block Party on October 29th. Please see our ad above and reach out for volunteer opportunities.

***Getty Event 10/16:***

In addition our Getty Liaison, Renee Weitzer, has exciting news with the Getty opening their doors to their Malibu & Palisades neighbors for an exclusive showing of NUBIA: Jewels of Ancient Sudan. Please see the above ad and RSVP by October 10th. These are two incredible events that were brought together through the leadership of those in the community and help to push forward the boards goals of re-establishing community bonds.

On other fronts – the board continues to thoughtfully execute against our stated goals. This month we approved a pilot program with Flock to install a camera in a highly strategic location in the neighborhood. We will assess its effectiveness and decide at a later date whether to expand the initiative, continue as is or cancel.

In the coming months we will launch a formal project with the goal of strengthening the Association’s long term financial viability and bolstering our ability to continue defending the community’s covenants, conditions and restrictions. We took the first step as part of the By-Law language clarification approved as part of the 2022 election. The next phase will be a clear and thoughtful approach to dues and membership. This will not be a linear path but is founded in a fundamental belief that we as a membership need to do more to strengthen our Association so that we can re-invest in productive enhancements for the Sunset Mesa community while defending it from the continued threat of overdevelopment, environmental perils and crime.

I look forward to your participation and your patience as we roll this out. See you on October 29th!

|                   |   |                                      |   |                                    |  |  |
|-------------------|---|--------------------------------------|---|------------------------------------|--|--|
| <b>Spotlights</b> | <a href="#"><i>Mesa Block Party</i></a> | <a href="#"><i>Safety Update</i></a> | <a href="#"><i>Treasurer’s Report</i></a> | <a href="#"><i>Mesa Museum</i></a> | <a href="#"><i>Emergency Prep Report</i></a> | <a href="#"><i>Memos from Ms. Mesa</i></a> |
|                   | Page 2                                  | Page 3                               | Page 4                                    | Page 6                             | Page 7                                       | Page 9                                     |

## Initiative Spotlight - Return of the Mesa Block Party!

We're looking for volunteers and sponsors to join the Block Party Committee and help plan an awesome community event! Please email [smpoaboard@gmail.com](mailto:smpoaboard@gmail.com) if you are interested!



YOUR SMPOA PRESENTS

# THE SUNSET MESA

## BU BASH BLOCK PARTY!

COSTUMES  
MUSIC | FOOD | FUN

Save the Date:

# OCTOBER 29TH

Clifftop Way 3:30-6:30PM

WE NEED HELP FROM VOLUNTEERS!  
ALSO LOOKING FOR DONATIONS, SPONSORS & RAFFLE ITEMS!

CONTACT US FOR MORE INFO!

CONTACT: [SMPOABOARD@GMAIL.COM](mailto:SMPOABOARD@GMAIL.COM)

### SPONSORSHIP OPPORTUNITIES

|               |       |
|---------------|-------|
| MUSIC         | \$500 |
| TABLES        | \$500 |
| CHAIRS        | \$500 |
| PETTING ZOO   | \$500 |
| CRAFT TABLES  | \$250 |
| FACE PAINTING | \$250 |

### BENEFITS TO OUR SPONSORS

- ★ Thank You Acknowledgement in the Mesa Monthly Newsletter
- ★ Family Name Signage in Recognition of Support at Party
- ★ Sunset Mesa Gift

# SMPOA Treasurer's Report

| Summary SMPOA Financials for August 2022                     |                   |
|--|-------------------|
| Banc of CA (BCA) — Business Checking                         | \$ 19,873         |
| Stifel Investment  | \$ 362,838        |
| <b>TOTAL SMPOA ASSETS</b>                                    | <b>\$ 382,711</b> |
| Escrow Doc Fees, Advertising, Past & CY-2022 Dues Collection | \$ 1,600          |
| <b>TOTAL REVENUE</b>   | <b>\$ 1,600</b>   |
| Legal  | \$ 1,194          |
| QuickBooks Fees  | \$ 3              |
| Newsletter Printing July                                     | \$ 496            |
| <b>TOTAL EXPENSES</b>  | <b>\$ 1,693</b>   |
| <b>NET OPERATING INCOME</b>                                  | <b>\$ (93)</b>    |
| <b>Stifel Investment Portfolio Activity</b>                  |                   |
| Income & Distributions                                       | \$ 752            |
| Unrealized Gain/Loss   | \$ (1,266)        |
| <b>NET CHANGE IN STIFEL PORTFOLIO</b>                        | <b>\$ (514)</b>   |

Net Operating Income for August 2022 was net negative \$93. Revenue of \$1,600 includes 2022 dues deposits and advertising revenue. Expense totaling \$1,693 comprise legal fees \$1,194 and newsletter printing \$496.

Block Party! Volunteers and sponsors desired! We've received donations from a couple families... looking forward to making the party excellent for all of you and need your help to do it.

Current Getty cards are available - feel free to contact [smpoaboard@gmail.com](mailto:smpoaboard@gmail.com). If you would like your Getty card right away please send a stamped addressed envelope to the Treasurer (address on invoice). Some residents have asked why we have not sent these out ... the answer is resources that we don't have. In order to meet the increasing demands of this community, we need volunteers to help on many fronts. If you would like to volunteer to handle a bulk mailing of Getty cards, please reach out to Desa @ [smpoaboard@gmail.com](mailto:smpoaboard@gmail.com)

About 215 members have outstanding balances across the community totaling +\$130k.

Many members have paid recent dues but have existing balances from 2012-2019. You may be unaware or the balances may be in error. When I took this role I owed dues from 2018 and had no idea! I paid them of course.

That said, a **gentle reminder that dues are not optional for membership benefits** in the Association including Block Party benefits and Architecture Committee support.

**Please reach out to the Treasurer to review and either 1) confirm your account is current, 2) fix wrong balances or 3) close out correct balances.**

A grateful thanks to everyone who has already.

*Interested in reaching the entire Sunset Mesa? Advertise!  
Contact [SMPOAboard@gmail.com](mailto:SMPOAboard@gmail.com) for more info*



# Getty Villa Neighborhood Appreciation Night

The Getty Villa is hosting a neighborhood appreciation event on **SUNDAY, OCTOBER 16th**. Be sure to register by **OCTOBER 10th** to attend!

The J. Paul Getty Trust cordially invites our Pacific Palisades neighbors to enjoy a wine and cheese reception and viewing of our newest exhibition:

## NUBIA JEWELS OF ANCIENT SUDAN

For nearly 3,000 years a series of kingdoms flourished in ancient Nubia (present-day southern Egypt and northern Sudan). The region was rich in sought-after resources such as gold and ivory and its trade networks reached Egypt, Greece, Rome, and central Africa. This exhibition presents highlights from the Museum of Fine Arts, Boston's extensive collection of Nubian objects and features superbly crafted jewelry, metalwork, and sculpture exhibiting the wealth and splendor of Nubian society.

Sunday, October 16, 2022  
3:00 to 5:30 pm

The Getty Villa (Business Entrance)  
17901 Los Liones Dr.  
Pacific Palisades, CA 90272

RSVP by October 10  
<https://bit.ly/gv-neighbor-fall2022>  
(310) 440-7300

Complimentary parking

Exhibition organized  
by the Museum of  
Fine Arts, Boston



**Interested in reaching the entire Sunset Mesa? Advertise!  
Contact [SMPOAboard@gmail.com](mailto:SMPOAboard@gmail.com) for more info**



# Around the Neighborhood

## AC Report for August

- ❖ **3652 Malibu Vista Drive** - solar panels - Approved
- ❖ **3714 Malibu Vista Drive** - County caused OVI
- ❖ **18346 Wakecrest Drive** - 18341 Coastline Drive used to trim backyard trees to below the fence line as viewed from 18346 Wakecrest Drive Those trees causes OVI from interior living space. 18338 Wakecrest Drive has side hedges which should be trimmed to fence line.

Your Sunset Mesa Realtor & Neighbor

*Teresa LeGrove*

www.sunsetmesa.realty

310-889-8851

teresa@teresalegrove.com



COLDWELL BANKER  
REALTY



CalDRE #01998138

Selling, Buying & Leasing for Over a Decade

*Volunteers requested! The AC is a dedicated team of residents some of whom have served for years. Please email us if you're interested in helping!*

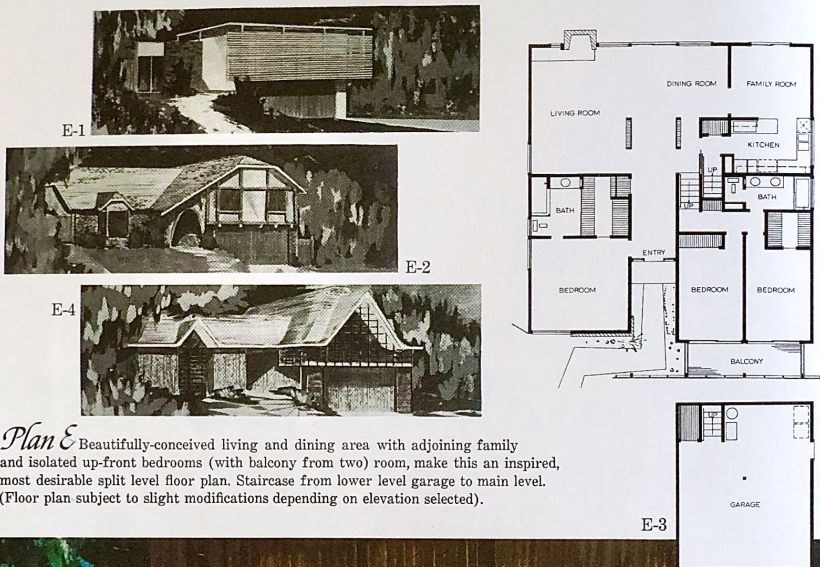

*Plan E* Beautifully-conceived living and dining area with adjoining family and isolated up-front bedrooms (with balcony from two) room, make this an inspired, most desirable split level floor plan. Staircase from lower level garage to main level. (Floor plan subject to slight modifications depending on elevation selected).



## The Mesa Museum

This month we feature “Plan E”. With 4 variations, Plan E has a “Beautifully conceived living and dining area with adjoining family and isolated up-front bedrooms (with balcony for two), make this an inspired, most desirable split level floor plan. Staircase from lower level garage to the main level.”

## Website Update

Our website has a slightly new look! Check it out at [sunsetmesa.org](http://sunsetmesa.org)

# Memos from Ms. Mesa

## Cocktail of the Month

By Ms. Mesa

### Witches Brew ...

- ★ 2 oz Vodka
- ★ 2 oz Triple Sec
- ★ 2 oz Blue Curacao
- ★ Juice of One Lime
- ★ Black sanding sugar rim (or crushed black sprinkles will work too)

Shake with dry ice for smoky spookiness!

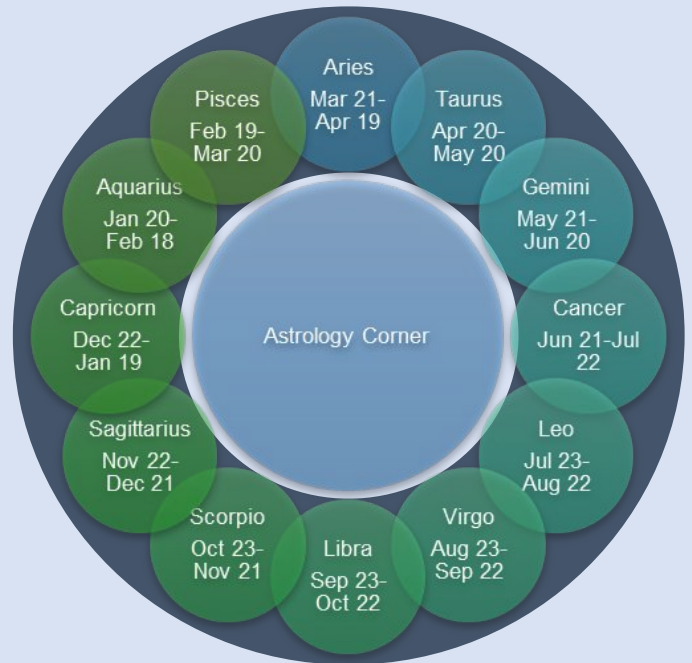

## Where are the Doggie Bags?

One benefit provided by the SMPOA is a supply of pet waste bags. These bags and dispenser stations are funded from our dues and are intended to help keep the neighborhood beautiful. The locations of the dispensers have been updated recently to try to more evenly cover the neighborhood. We previously had an over abundance of stations in the center of the neighborhood (near the corner of Wakecrest and Castlerock) but few on the perimeter. This was addressed in the spring of 2022 by relocating one station to the intersection of W Clifftop way and Castlerock. We also had a lack of stations in the western part of the community. This has been solved by adding a new station at the corner of Wakecrest and S Malibu Vista Drive. Please make use of these bags to collect your solid pet waste and dispose of it in YOUR OWN garbage. We consume about 1300 bags a month. That is a lot of waste being picked up.

Congrats and thanks,

Mark Estes

## Ms. Mesa's Astrology Corner

### Favorite Halloween Decor

- ❖ **Aquarius** Jan 20-Feb 18: *A ghostly apparition*
- ❖ **Pisces** Feb 19-Mar 20: *Spider webs*
- ❖ **Aries** Mar 21-Apr 19: *Dry Ice*
- ❖ **Taurus** Apr 20-May 20: *Tombstones of buried grudges*
- ❖ **Gemini** May 21-Jun 20: *Creepy clown*
- ❖ **Cancer** Jun 21-Jul 22: *Norman Bates-style mannequin in the window*
- ❖ **Leo** Jul 23-Aug 22: *Pretty candy corn bowl*
- ❖ **Virgo** Aug 23-Sep 22: *One pumpkin per child*
- ❖ **Libra** Sep 23-Oct 22: *Lots of candles*
- ❖ **Scorpio** Oct 23-Nov 21: *Lots of skulls*
- ❖ **Sagittarius** Nov 22-Dec 21: *Rings of candy*
- ❖ **Capricorn** Dec 22-Jan 19: *Advanced haystack and pumpkin arrangement not unlike a mini underwood farms display*